

Rev.	Description	Date	Sign
1.4	Added support for pins and HMS logotype	2013-09-30	RiA
1.5	Added pcb-outline to pcb-layout	2014-05-05	RiA
1.6	Updated PCB outline value	2014-07-16	RiA

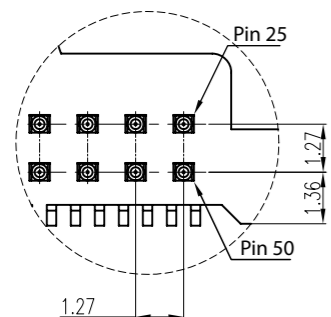

DETAIL C
SCALE:5:1

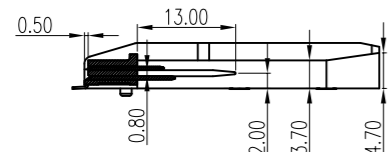
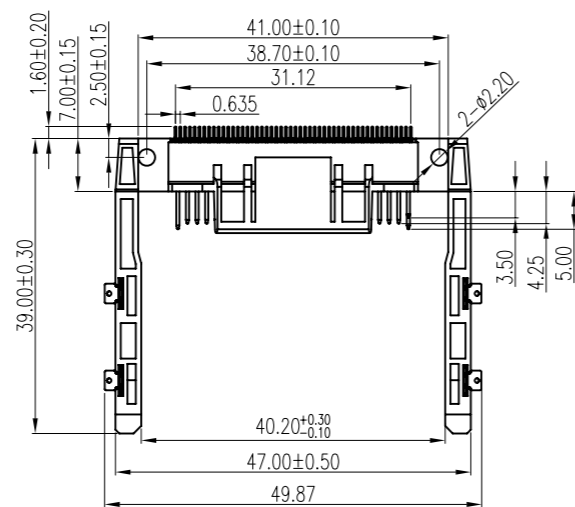

SECTION: B-B

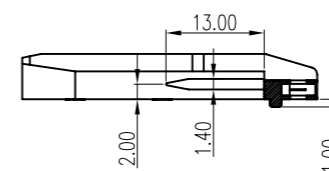
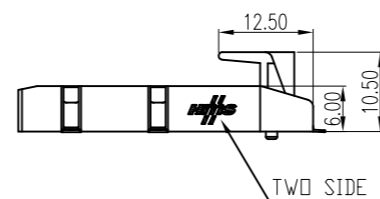
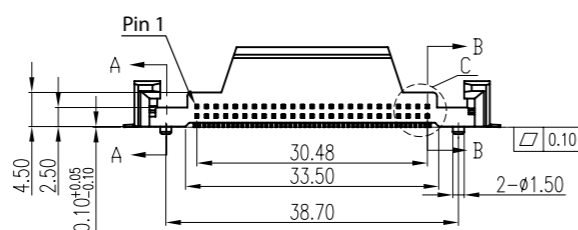

SECTION A-A

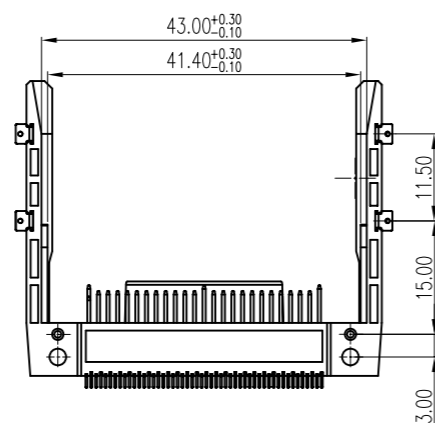

Recommended PCB-layout
General tolerances $\pm 0,05\text{mm}$

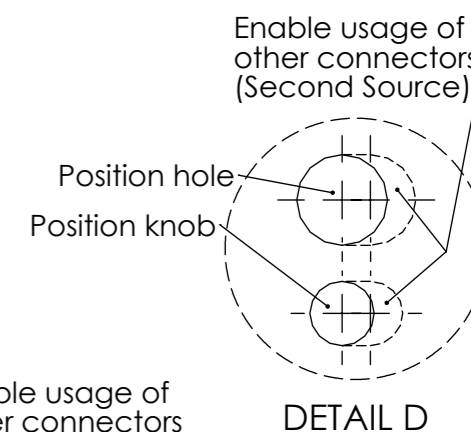
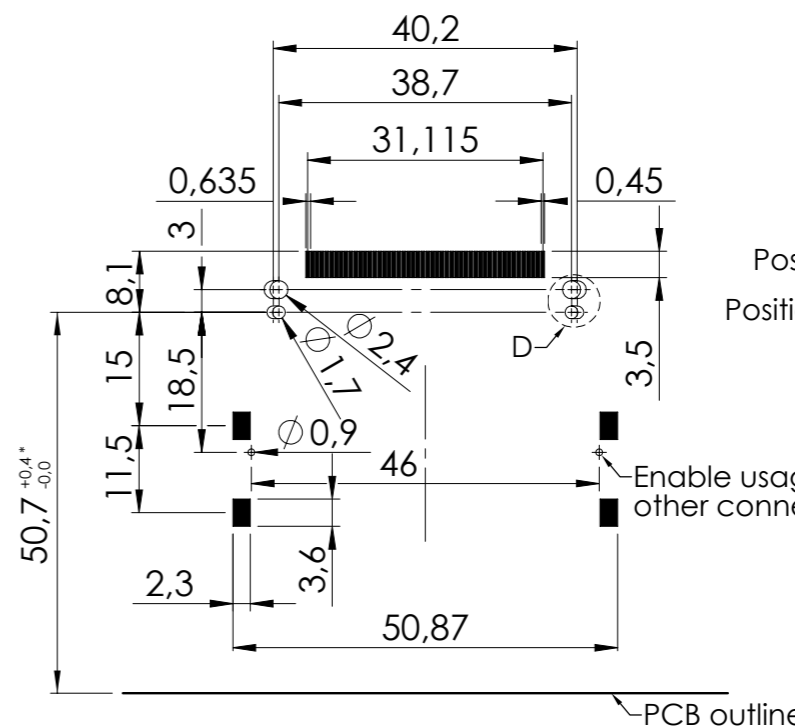

* For PCB and drill-hole tolerances

Note:

- Housing: LCP(Liquid Crystal Polymer)
Color:Natural,Thermoplastic,UL 94 V-0
- Contact: Copper Alloy
- Operation voltage: 100 VAC max
- Current rating: 0.5 Amp.
- Contact resistance: 40m ohms max.
- Insulation resistance: 1000M ohms min 500 VDC.
- Dielectric withstanding voltage: 500VAC/1minute.
- Operating Temperature: -40° C to +85° C
- Resistance to Solder Heat :
Temperature: 260° C
Immersion duration: 10sec.
- Durability: 5000 Cycles
- Finish/Plated:
Terminal:15u" min Au Plated on Contact Area,
100u" min Tin Plated on solder area,
50u" min Ni Under Plated over all
Grounded Pin: 80u" min Tin Plated on solder area,
50u" min Ni Under Plated over all
- RoHS and REACH compliant
- Storage -25 - 65°C, 0 - 90% RH



Owner HMS Industrial Networks AB		Scale 1:1	Size	Weight	Finishing																				
Stationsgatan 37 S-302 45 Halmstad Tel: +46 (0)35 - 17 29 00 Fax: +46 (0)35 - 17 29 09		<table border="1"> <thead> <tr> <th>DIM.</th> <th>TOL.</th> <th>DIM.</th> <th>TOL.</th> </tr> </thead> <tbody> <tr> <td>X.</td> <td>± 0,30</td> <td>X.</td> <td>± 2,00°</td> </tr> <tr> <td>X,X</td> <td>± 0,25</td> <td>X,X</td> <td>± 1,0°</td> </tr> <tr> <td>X,XX</td> <td>± 0,15</td> <td>X,XX</td> <td>± 0,5°</td> </tr> <tr> <td>X,XXX</td> <td>± 0,10</td> <td>X,XXX</td> <td>± 0,2°</td> </tr> </tbody> </table>		DIM.	TOL.	DIM.	TOL.	X.	± 0,30	X.	± 2,00°	X,X	± 0,25	X,X	± 1,0°	X,XX	± 0,15	X,XX	± 0,5°	X,XXX	± 0,10	X,XXX	± 0,2°	Title Compact Flash connector HMS	
DIM.	TOL.	DIM.	TOL.																						
X.	± 0,30	X.	± 2,00°																						
X,X	± 0,25	X,X	± 1,0°																						
X,XX	± 0,15	X,XX	± 0,5°																						
X,XXX	± 0,10	X,XXX	± 0,2°																						
Sign: RiA	Date: 20120313	Rev. 1.6	Sheet: 1 of 1	Document nr SDH-7018-202	HMS nr SP1137																				