



(1,27mm) .050"

CLP SERIES

CLP-107-02-F-D-P

CLP-115-02-L-D

CLP-130-02-L-D

CLP-116-02-F-DH

LOW PROFILE DUAL WIPE SOCKET

SPECIFICATIONS

For complete specifications and recommended PCB layouts see www.samtec.com?CLP

Insulator Material:
Black Liquid Crystal Polymer



Contact Material:
Phosphor Bronze
Plating: Sn or Au over 50µ" (1,27µm) Ni

Current Rating:
1.75A @ 80°C ambient
Operating Temp Range:
-55°C to +125°C

Contact Resistance:
10 mΩ max

Insertion Depth:
Top Entry = (1,40mm) .055" minimum, Bottom Entry = (2,41mm) .095" minimum plus board thickness
DH Entry = (2,31mm) .091" to (2,67mm) .105"

Insertion Force:
(Single contact only)
3.8oz (1,05N) average

Normal Force:
60 grams (0,59N) average

Withdrawal Force:
(Single contact only)
2oz (0,56N) average

Max Cycles:
100 with 10µ" (0,25µm) Au

RoHS Compliant:
Yes

Processing:
Lead-Free Solderable:
Yes

SMT Lead Coplanarity:
(0,10mm) .004" max (02-35)
(0,15mm) .006" max (36-50)

Mates with:
FTSH, FTS,
FW, FFDL2



High reliability
Tiger Claw™ contacts

(1,27mm x 1,27mm)
.050" x .050"
micro pitch

Low Profile
(2,21mm)
.087"

Surface Mount

Suitable for pass-through applications

APPLICATIONS



HORIZONTAL



PASS-THRU

1,27mm FTSH/CLP	Rated @ 3dB Insertion Loss
5,13mm Stack Height	
Single-Ended Signaling	7.0 GHz / 14 Gbps
Differential Pair Signaling	8.5 GHz / 17 Gbps

Performance data for other stack heights and complete test data available at www.samtec.com?CLP or contact sig@samtec.com

1,27mm FW/CLP	Rated @ 3dB Insertion Loss
17,7mm Stack Height	
Single-Ended Signaling	3.0 GHz / 6.0 Gbps
Differential Pair Signaling	4.0 GHz / 8.0 Gbps

Performance data for other stack heights and complete test data available at www.samtec.com?CLP or contact sig@samtec.com

CLP - 1 NO. PINS PER ROW - 02 - PLATING OPTION - ROW OPTION - OTHER OPTION

02 thru 50

CLP-110-02-L-D-A

- F = Gold flash on contact, Matte Tin on tail
- L = 10µ" (0,25µm) Gold on contact, Matte Tin on tail
- G = 10µ" (0,25µm) Gold (-D only)

- D = Double Row
- DH = Double Horizontal (Requires FTSH or FSH -01 lead style)

- BE = Bottom Entry (Required for bottom entry applications)

- A = Alignment Pin (Not available with -PA option) (5, 10, 25 positions only) (-DH option and other sizes. Call Samtec)

- K = (4,00mm) .157" DIA Polyimide film Pick & Place Pad (5 positions min.)

- P = Pick & Place Pad (5 positions min. -D only) (Not always necessary for auto placement. See Flex Processing.)

- PA = Pick & Place Pad with Alignment Pin (-D only) (Not Available with -A option)

- TR = Tape & Reel

ALSO AVAILABLE
Single row available. (Mates with FTS Series) Call Samtec.

APPLICATION SPECIFIC OPTION
Single row options available. Call Samtec.

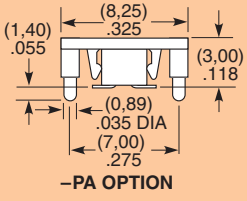
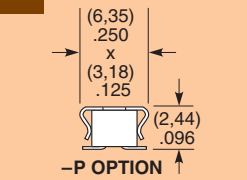
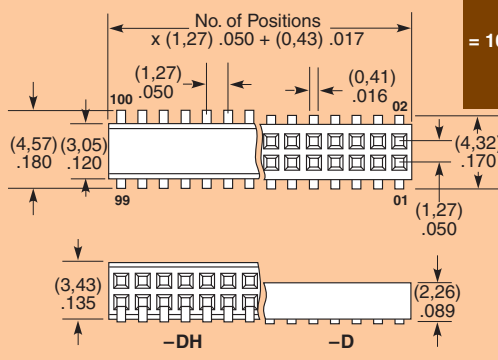

PIN/ROW	A
04-15	(3,56) .140
16-50	(7,11) .280

If odd pins/row, alignment pins are on middle position on centerline of the part. If even pins/row, then alignment pins are between middle two positions.

Note: Other Gold plating options available. Contact Samtec.
Note: Some sizes, styles and options are non-standard, non-returnable.

Due to technical progress, all designs, specifications and components are subject to change without notice.

WWW.SAMTEC.COM

DO NOT SCALE FROM THIS PRINT

1. $\text{\textcircled{C}}$ REPRESENTS A CRITICAL DIMENSION
2. MINIMUM PUSHOUT FORCE: .5LB (8 OZ)
3. ONE POSITION WILL BE LOST FOR EVERY CUT MADE ON A SOCKET STRIP
4. TUBE PACKAGE POSITIONS 5-50 ONLY. POSITIONS 2-4 ARE TO BE LAYERED PACKAGED.
5. SHEAR TAILS TO DIMENSIONS SHOWN
6. PARTS TO BE SYMMETRICAL ABOUT \bar{C} WITHIN $\pm .0015[0.038]$.
7. ENDWALL AFTER CUTTING: $.0185[0.470] \pm .0025[0.064]$
8. VOID CORES MAY NOT BE PRESENT.
9. HAND FILL USE C-106-01-XX.
AUTOMATION USE C-106-22-XX. C-106-02-XX CAN BE SUBBED FOR C-106-22-XX.
- $\text{\textcircled{C}}$ 10. MAX CUT FLASH: $.010[0.27]$ WITH NO FLASH ALLOWED IN HOLES OR EXTENDING BELOW LEADS.
- $\text{\textcircled{C}}$ 11. MAX BURR: $.005[.13]$.

CLP-1XX-XX-XXX-D-XX

No OF POSITIONS PER ROW
-02 THRU -50

LEAD STYLE SPEC
-02: SURFACE MOUNT
(USE C-106-X2-XXX)
(SEE NOTE 9)

OPTION

- P: PICK & PLACE PAD (USE LMP-01)
(AVAILABLE ON POSITION -05 THRU -50 ONLY)
(NOT AVAILABLE WITH -PA OR -K OPTIONS)
(SEE FIG. 3, SHT 2)
- A: ALIGNMENT PIN (USE CLP-XX-D-XX)
(NOT AVAILABLE WITH -PA OPTION)
(SEE FIG. 3, SHT 2)
- TR: TAPE AND REEL
- BE: BOTTOM ENTRY ONLY (USE CLP-XX-DBE-XX)
- PA: PICK & PLACE PAD WITH ALIGNMENT PINS
(NOT AVAILABLE WITH -P, -A, OR -K OPTIONS)
(SEE SHT 2, TABLE 3)
- K: POLYIMIDE FILM PAD (POSITIONS -05 THRU -50 ONLY)
(USE K-500-300, SEE FIG. 5, SHT 2)
(.005[0.13] THICKNESS WITH SILICONE ADHESIVE)
(NOT AVAILABLE WITH -P OR -PA OPTIONS)

BODY SPEC

- D: DOUBLE ROW
(USE CLP-XX-D)

PLATING SPEC

- F: 3μ " FLASH SELECTIVE GOLD IN CONTACT AREA
MATTE TIN ON TAIL
- L: 10μ " LIGHT SELECTIVE GOLD IN CONTACT AREA
MATTE TIN ON TAIL
- S: 30μ " SELECTIVE GOLD IN CONTACT AREA
MATTE TIN ON TAIL
- G: 10μ " GOLD IN CONTACT AREA
 3μ ON TAIL
- H: 30μ " HEAVY GOLD IN CONTACT AREA
 3μ ON TAIL
- LM: 10μ " LIGHT SELECTIVE GOLD IN CONTACT AREA
MATTE TIN ON TAIL
- FM: 3μ " FLASH SELECTIVE GOLD IN CONTACT AREA
MATTE TIN ON TAIL
- SM: 30μ " SELECTIVE GOLD IN CONTACT AREA
MATTE TIN ON TAIL
- LTL: 10μ " LIGHT SELECTIVE GOLD IN CONTACT AREA
TIN/LEAD (90/10+/-5%) TAIL

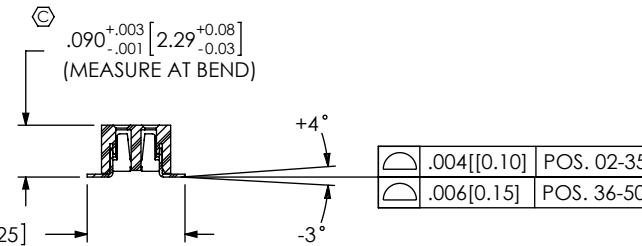
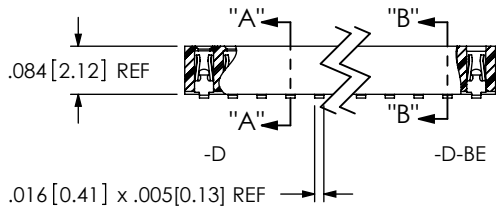
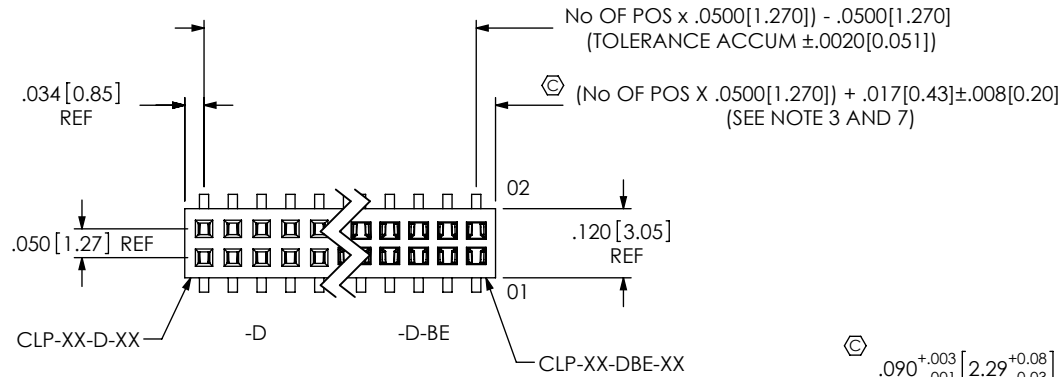

SECTION "A"- "A"
(-D BODY: CLP-XX-D-XX)



SECTION "B"- "B"
(-D-BE BODY: CLP-XX-DBE-XX)
(DIFFERENT AS SHOWN,
OTHERWISE SAME AS -D BODY)

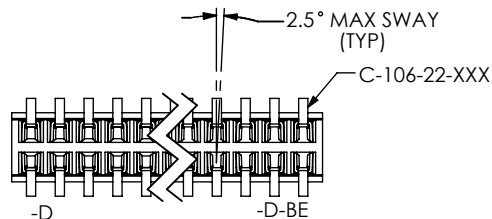

FIG 1

UNLESS OTHERWISE SPECIFIED,
DIMENSIONS ARE IN INCHES.
TOLERANCES ARE:
DECIMALS ANGLES
.XX: $\pm .01$ [.3] 2°
.XXX: $\pm .005$ [.13]
.XXXX: $\pm .0020$ [.051]

PROPRIETARY NOTE

THIS DOCUMENT CONTAINS INFORMATION
CONFIDENTIAL AND PROPRIETARY TO
SAMTEC, INC. AND SHALL NOT BE REPRODUCED
OR TRANSFERRED TO OTHER DOCUMENTS OR
DISCLOSED TO OTHERS OR USED FOR ANY
PURPOSE OTHER THAN THAT WHICH IT WAS
OBTAINED WITHOUT THE EXPRESSED WRITTEN
CONSENT OF SAMTEC, INC.



520 PARK EAST BLVD., NEW ALBANY, IN 47150
PHONE: 812-944-6733 FAX: 812-948-5047
e-Mail: info@SAMTEC.com code 53322

MATERIAL: DO NOT SCALE DRAWING SHEET SCALE: 3:1

DESCRIPTION:
LOW PROFILE .050 x .050 DOUBLE ROW ASM

INSULATOR: LCP, UL 94 VO, COLOR: BLACK
CONTACT: PHOS BRONZE

DWG. NO. CLP-1XX-XX-XXX-D-XX

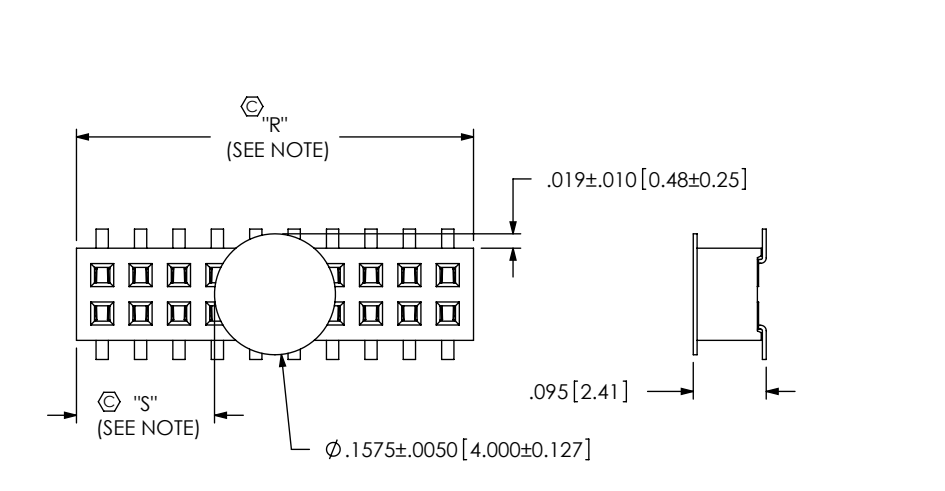
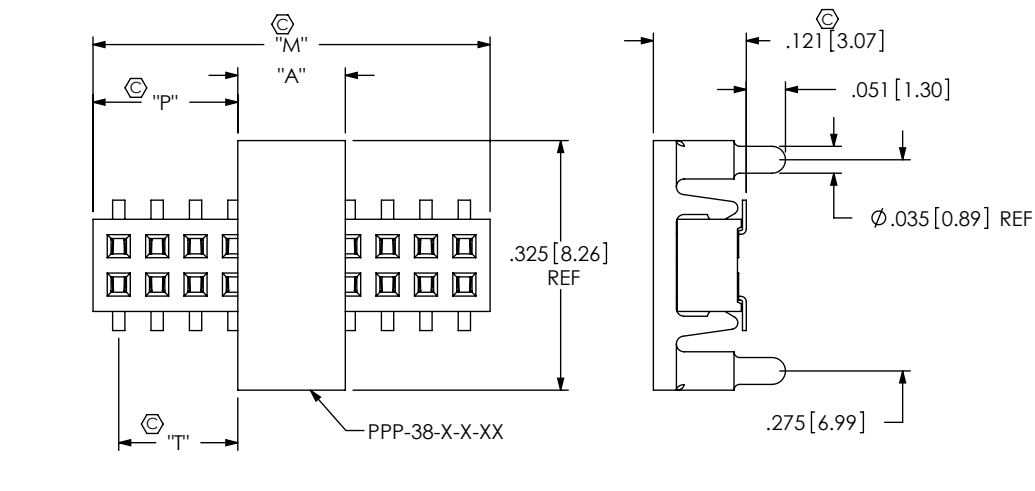
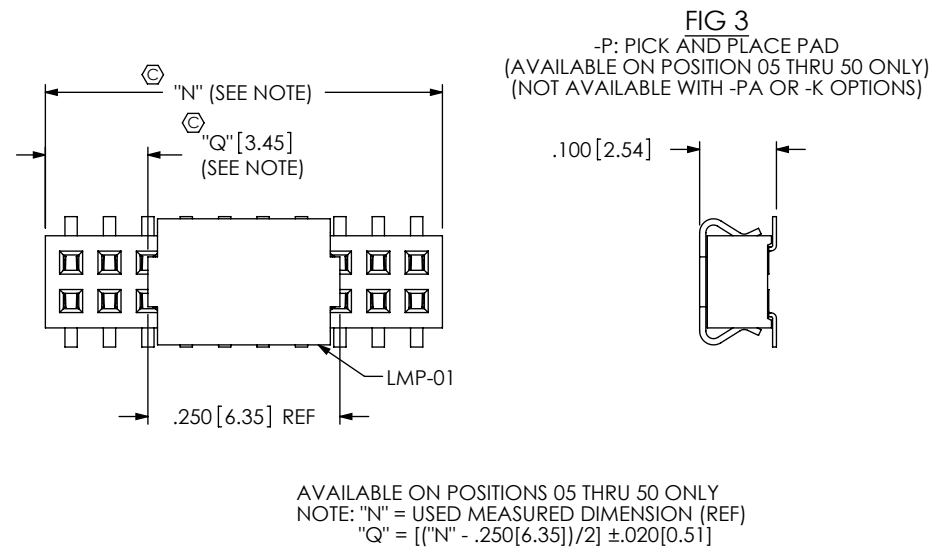
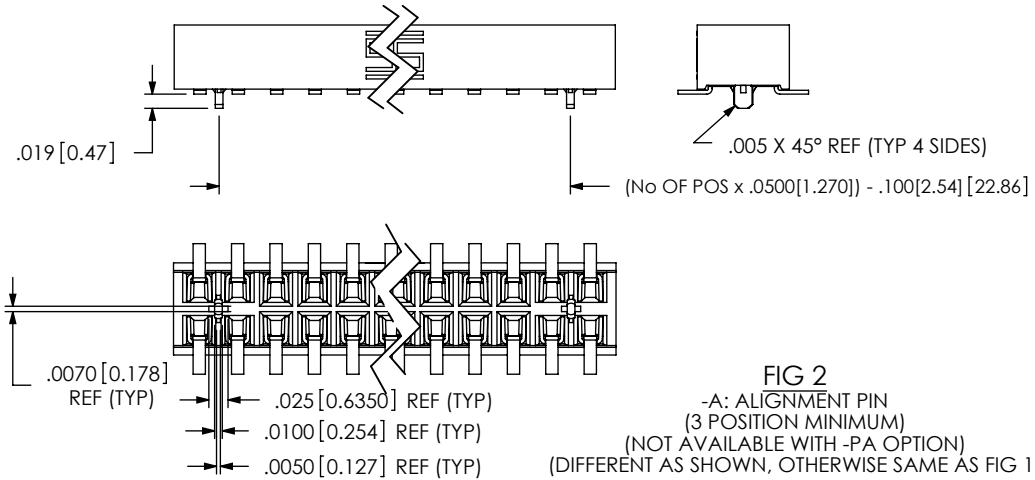

TABLE 1

POS/ROW	"A"	"M"	"P"
4-15	.140 [3.56] REF	USED MEASURED DIMENSION (REF)	[{"M" - "A"} / 2] ± .020 [0.51]
16-50	.280 [7.11] REF		

TABLE 3

POS/ROW	PIN COUNT	PAD	"T"
4-15	ODD	PPP-38-O-4-15	(((No OF POS.-1)/2)x.050 [1.27])-.070 [1.78]
	EVEN	PPP-38-E-4-15	
16-50	ODD	PPP-38-O-16-50	(((No OF POS.-1)/2)x.050 [1.27])-.140 [3.56]
	EVEN	PPP-38-E-16-50	

PROPRIETARY NOTE
 THIS DOCUMENT CONTAINS INFORMATION CONFIDENTIAL AND PROPRIETARY TO SAMTEC, INC. AND SHALL NOT BE REPRODUCED OR TRANSFERRED TO OTHER DOCUMENTS OR DISCLOSED TO OTHERS OR USED FOR ANY PURPOSE OTHER THAN THAT WHICH IT WAS OBTAINED WITHOUT THE EXPRESSED WRITTEN CONSENT OF SAMTEC, INC.

DO NOT SCALE DRAWING

SHEET SCALE: 4:1

520 PARK EAST BLVD, NEW ALBANY, IN 47150
 PHONE: 812-944-6733 FAX: 812-948-5047
 e-Mail: info@SAMTEC.com code 55322

DESCRIPTION:
 LOW PROFILE .050 x .050 DOUBLE ROW ASM
 DWG. NO. CLP-1XX-XX-XXX-D-XX
 BY: PURVIS 01/31/1994 SHEET 2 OF 3

PACKAGING
(SEE NOTE 4, SHEET 1)

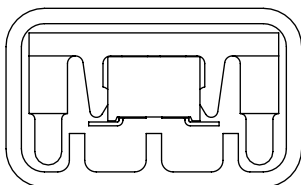

PT-CLP001-PA

TABLE 2		
OPTION	TUBE	PLUG
NONE, -A	PT-CLX001-D	TP-33
-P, -A-P	PT-CLX002-D	TP-33
-A-K, -K	PT-CLX001-D	TP-33
-PA	PT-CLP001-PA	TP-24-02

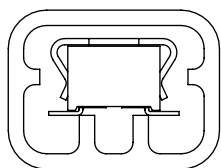

PT-CLX-002-D

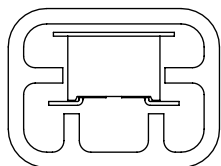

PT-CLX-001-D

CG

PROPRIETARY NOTE

THIS DOCUMENT CONTAINS INFORMATION CONFIDENTIAL AND PROPRIETARY TO SAMTEC, INC. AND SHALL NOT BE REPRODUCED OR TRANSFERRED TO OTHER DOCUMENTS OR DISCLOSED TO OTHERS OR USED FOR ANY PURPOSE OTHER THAN THAT WHICH IT WAS OBTAINED WITHOUT THE EXPRESSED WRITTEN CONSENT OF SAMTEC, INC.

DO NOT SCALE DRAWING

SHEET SCALE: 4:1



520 PARK EAST BLVD, NEW ALBANY, IN 47150
PHONE: 812-944-6733 FAX: 812-948-5047
e-Mail info@SAMTEC.com code 55322

DESCRIPTION:
LOW PROFILE .050 x .050 DOUBLE ROW ASM

DWG. NO. CLP-1XX-XX-XXX-D-XX

BY: PURVIS 01/31/1994 SHEET 3 OF 3

RECOMMENDED P.C. BOARD LAYOUT FOR CLP (SURFACE MOUNT)

REV. C

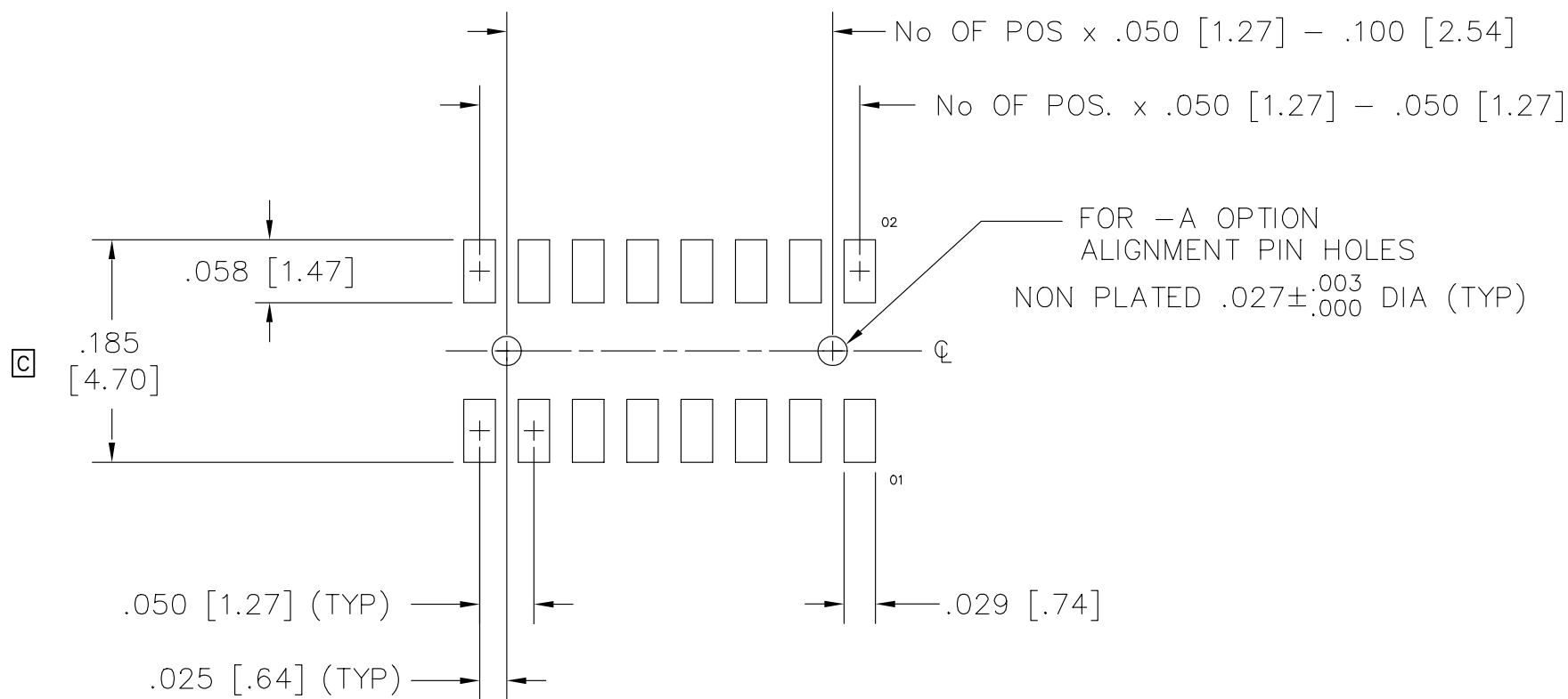

samtec
 MISC\MKTG\FOOTPRINT
 CLP-DV

520 PARK EAST BLVD. NEW ALBANY, INDIANA 47150
 PHONE (812) 944-6733 P.O. BOX 1147

PLOT SCALE: 1 = .1