

DO NOT SCALE FROM THIS PRINT

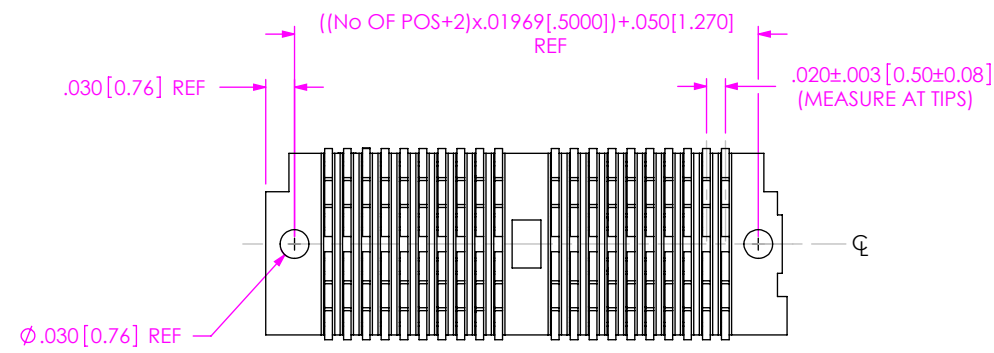
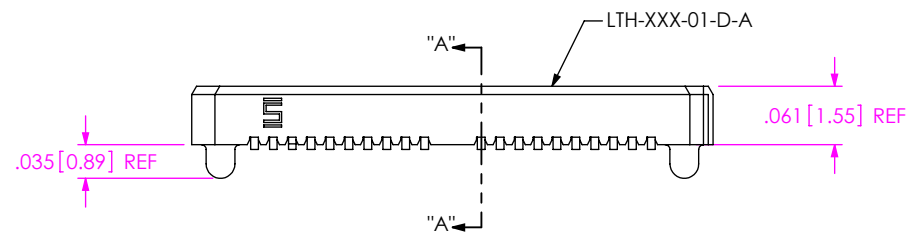
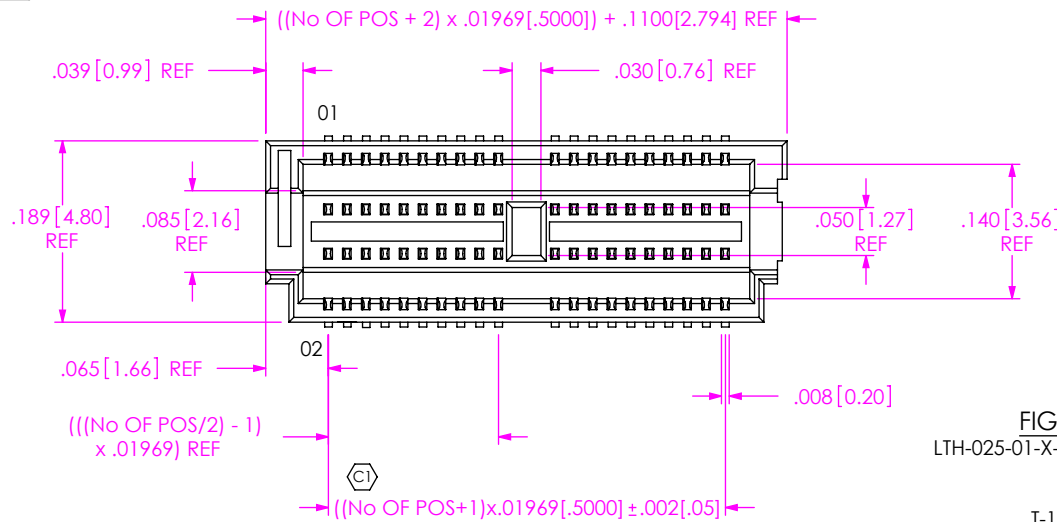

LTH-XXX-XX-X-D-A-XX
LTH-010-01-G-D-A

No OF POSITIONS
-010, -020, -030, -040, -050, (PER ROW)

OPTION
-TR: TAPE AND REEL
-K: POLYAMIDE FILM PAD (USE K-500-300, SEE FIG. 2)

LEAD STYLE
-01: SURFACE MOUNT (USE T-1M18-01-X PIN)

PLATING SPECIFICATION
-G: GOLD (USE T-1M18-01-G)
-H: HEAVY GOLD (USE T-1M18-01-H)

-A: ALIGNMENT PIN

ROW SPECIFICATION
-D: DOUBLE (USE LTH-XXX-01-D-A)

FIG. 1
LTH-025-01-X-D-A SHOWN

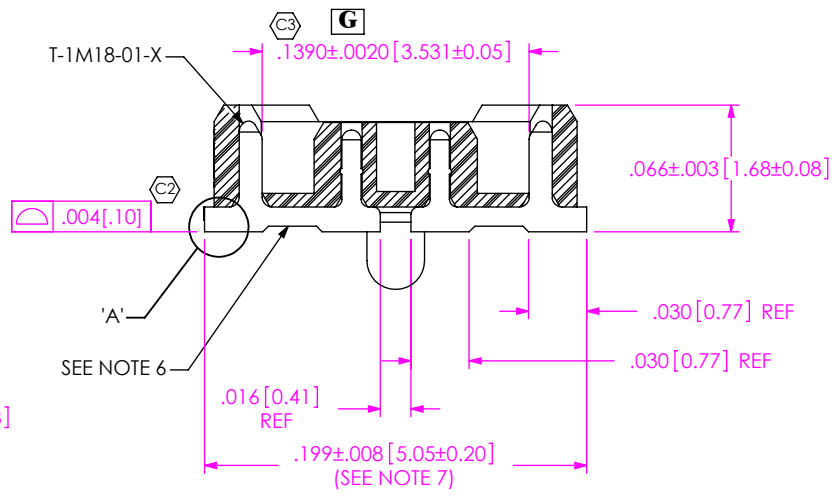

SECTION "A"- "A"
SCALE TO: 1

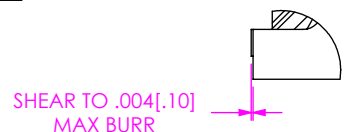

25-05382

DETAIL 'A'
SCALE 20: 1

NOTES:

- Ⓢ REPRESENTS A CRITICAL DIMENSION.
- BURR ALLOWANCE: .001[.03] MAX.
- MINIMUM PUSHOUT FORCE: 6 OZ MIN.
- PARTS TO BE MOLDED TO POSITION
- NOTE DELETED
- CUT IN THIS AREA MUST BE BELOW SURFACE MOUNT LEADS.
- MAX VARIATION BETWEEN ADJACENT PINS TO BE .005[.13] MAX.
- SAMTEC RECOMMENDS RIGHT-SIDE-UP, SINGLE PASS, 63/37 TIN/LEAD REFLOW SOLDERING.**
- THIS PART IS NOT COMPATIBLE WITH LEAD FREE REFLOW SOLDERING.**

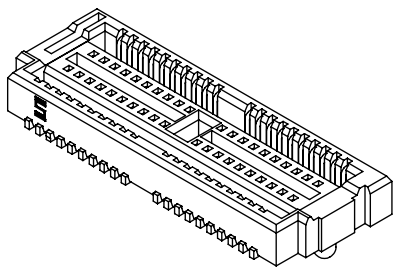

UNLESS OTHERWISE SPECIFIED, DIMENSIONS ARE IN INCHES. TOLERANCES ARE: DECIMALS .XX: ±.01[.3] .XXX: ±.005[.13] .XXXX: ±.0020[.051]		PROPRIETARY NOTE THIS DOCUMENT CONTAINS INFORMATION CONFIDENTIAL AND PROPRIETARY TO SAMTEC, INC. AND SHALL NOT BE REPRODUCED OR TRANSFERRED TO OTHER DOCUMENTS OR DISCLOSED TO OTHERS OR USED FOR ANY PURPOSE OTHER THAN THAT WHICH IT WAS OBTAINED WITHOUT THE EXPRESSED WRITTEN CONSENT OF SAMTEC, INC.	
MATERIAL: DO NOT SCALE DRAWING INSULATOR: BLACK LCP CONTACT: PHOS. BRONZE		SHEET SCALE: 5:1	
DESCRIPTION: .5mm LOW PROFILE TERMINAL ASSEMBLY		DWG. NO. LTH-XXX-XX-X-D-A-XX	
BY: ERIC M		7/1/99	
F:\DWG\MISC\MKTG\LTH-XXX-XX-X-D-A-XX-MKT.SLDRW		SHEET 1 OF 2	

FIG. 2
-K: POLYAMIDE FILM PAD
[USE K-500-300]

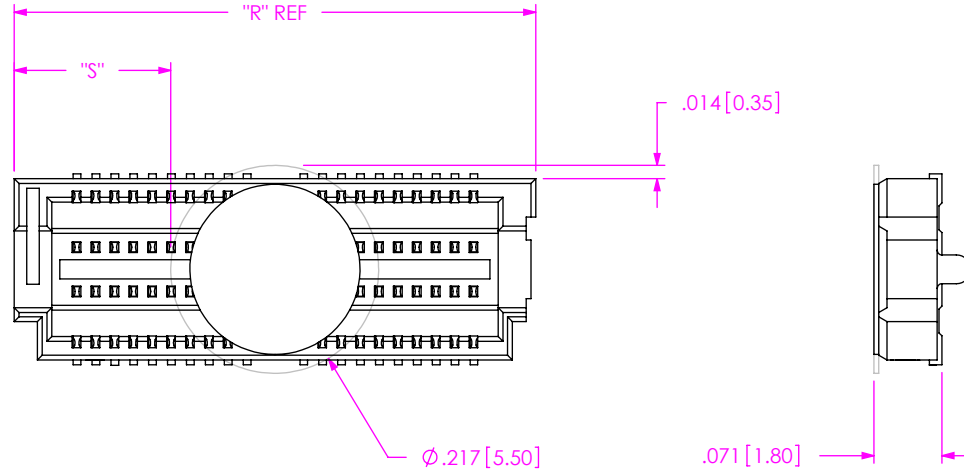

NOTE: "R" = ((No OF POSITIONS + 2) x .01969[.5000]) + .1100[2.794]
 "S" = (("R" - .217[5.50]) / 2) ±.020[.51]

PACKAGING VIEW
(PARTS TO HAVE POSITIONS #1 LOADED
IN SAME DIRECTION AS ARROW ON TUBE)

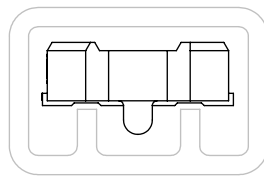

TUBE: PT-1-24-01-96
PLUG: TP-12

-K OPTION

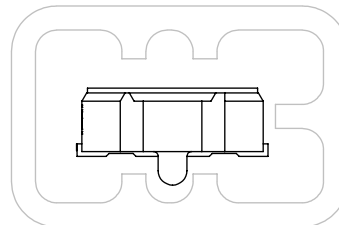

TUBE: PT-1-24-02-117
PLUG: TP-24

PROPRIETARY NOTE
THIS DOCUMENT CONTAINS INFORMATION
CONFIDENTIAL AND PROPRIETARY TO
SAMTEC, INC. AND SHALL NOT BE REPRODUCED
OR TRANSFERRED TO OTHER DOCUMENTS OR
DISCLOSED TO OTHERS OR USED FOR ANY
PURPOSE OTHER THAN THAT WHICH IT WAS
OBTAINED WITHOUT THE EXPRESSED WRITTEN
CONSENT OF SAMTEC, INC.

DO NOT SCALE DRAWING

SHEET SCALE: 5:1



520 PARK EAST BLVD, NEW ALBANY, IN 47150
PHONE: 812-944-6733 FAX: 812-948-5047
e-Mail: info@SAMTEC.com code: 55322

DESCRIPTION: .5mm LOW PROFILE TERMINAL ASSEMBLY

DWG. NO. LTH-XXX-XX-X-D-A-XX

BY: ERIC M 7/1/99 SHEET 2 OF 2

NOTES:

1. SAMTEC ONLY RECOMMENDS RIGHT-SIDE-UP, SINGLE PASS, 63/37 TIN/LEAD REFLOW SOLDERING.
2. NOT COMPATIBLE WITH LEAD FREE REFLOW SOLDERING.

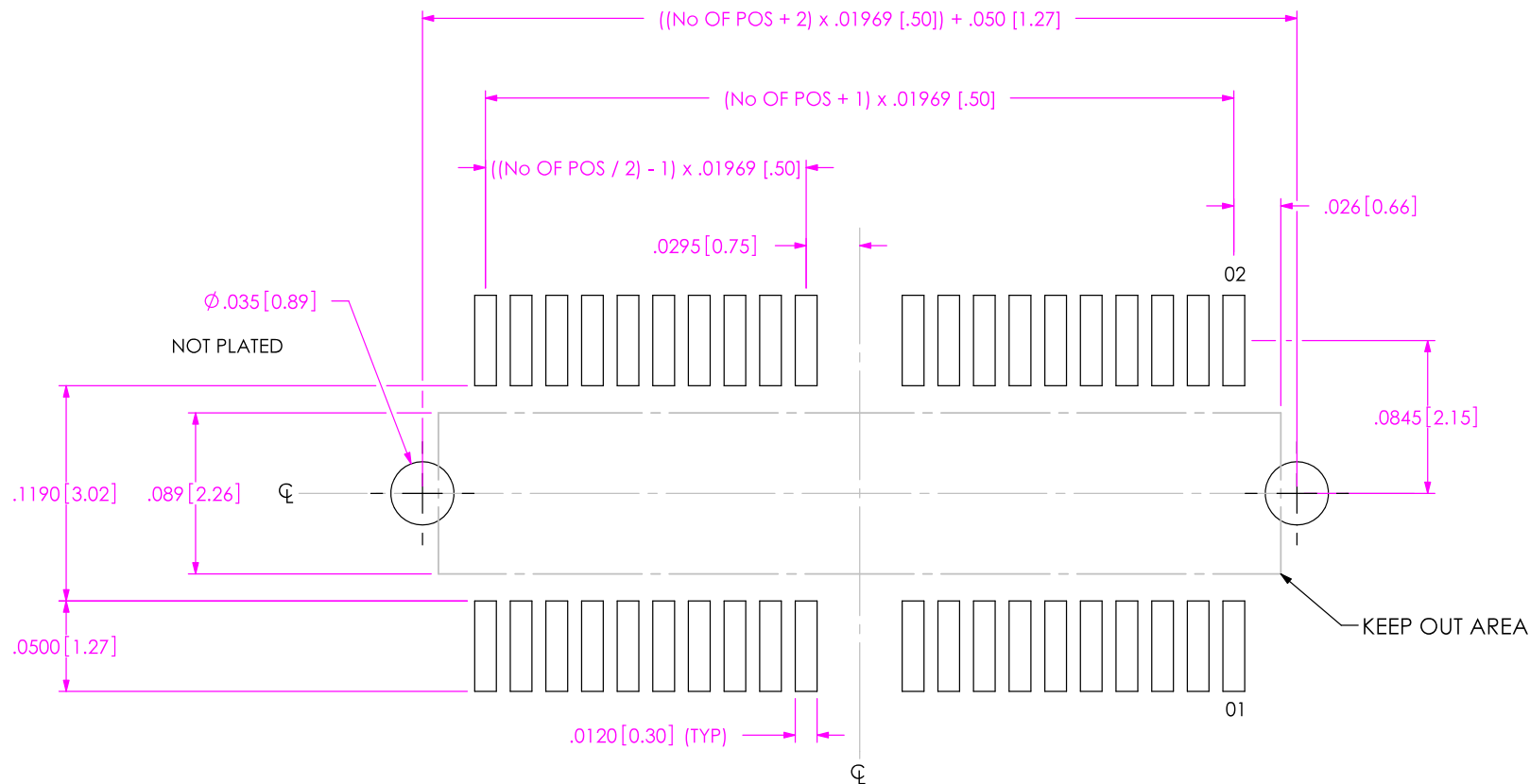

ALL DIMENSIONS ARE SYMMETRIC ABOUT THE CENTERLINE.



PROPRIETARY NOTE

THIS DOCUMENT CONTAINS INFORMATION CONFIDENTIAL AND PROPRIETARY TO SAMTEC, INC. AND SHALL NOT BE REPRODUCED OR TRANSFERRED TO OTHER DOCUMENTS OR DISCLOSED TO OTHERS OR USED FOR ANY PURPOSE OTHER THAN THAT WHICH IT WAS OBTAINED WITHOUT THE EXPRESSED WRITTEN CONSENT OF SAMTEC, INC.

SAMTEC

520 PARK EAST BLVD, NEW ALBANY, IN 47150
 * PHONE: 812.944.6733 FAX: 812.948.5047
 e-Mail: INFO@SAMTEC.COM CODE: 55322

NOTE:
STENCIL TO BE .0060 [.152] THICK.

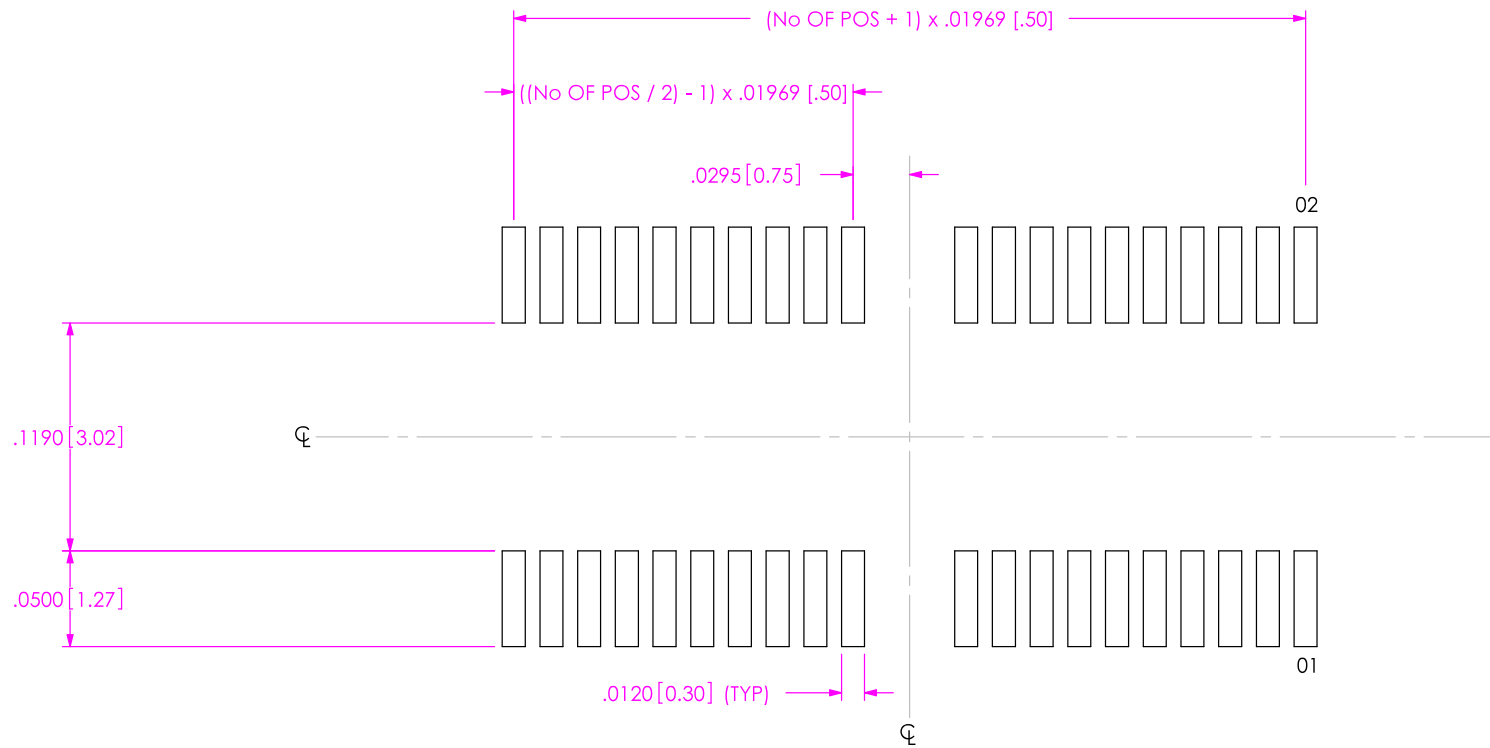

ALL DIMENSIONS ARE SYMMETRIC ABOUT THE CENTERLINE.



PROPRIETARY NOTE
THIS DOCUMENT CONTAINS INFORMATION CONFIDENTIAL AND PROPRIETARY TO SAMTEC, INC. AND SHALL NOT BE REPRODUCED OR TRANSFERRED TO OTHER DOCUMENTS OR DISCLOSED TO OTHERS OR USED FOR ANY PURPOSE OTHER THAN THAT WHICH IT WAS OBTAINED WITHOUT THE EXPRESSED WRITTEN CONSENT OF SAMTEC, INC.

SAMTEC
520 PARK EAST BLVD, NEW ALBANY, IN 47150
PHONE: 812.944.6733 FAX: 812.948.5047
e-Mail: INFO@SAMTEC.COM CODE: 55322