

RECOMMENDED PCB PATTERN

| CKT SIZE | A | B | C | D | E | F |
|----------|-------|-------|-------|-------|-------|-------|
| 4 | 6.65 | 4.85 | 2.00 | ----- | ----- | 5.00 |
| 6 | 8.65 | 6.85 | 4.00 | ----- | 2.00 | 7.00 |
| 8 | 10.65 | 8.85 | 6.00 | ----- | 4.00 | 9.00 |
| 10 | 12.65 | 10.85 | 8.00 | ----- | 6.00 | 11.00 |
| 12 | 14.65 | 12.85 | 10.00 | ----- | 8.00 | 13.00 |
| 14 | 16.65 | 14.85 | 12.00 | 8.00 | 10.00 | 15.00 |
| 16 | 18.65 | 16.85 | 14.00 | 10.00 | 12.00 | 17.00 |
| 18 | 20.65 | 18.85 | 16.00 | 12.00 | 14.00 | 19.00 |
| 20 | 22.65 | 20.85 | 18.00 | 14.00 | 16.00 | 21.00 |
| 22 | 24.65 | 22.85 | 20.00 | 16.00 | 18.00 | 23.00 |
| 24 | 26.65 | 24.85 | 22.00 | 18.00 | 20.00 | 25.00 |
| 26 | 28.65 | 26.85 | 24.00 | 20.00 | 22.00 | 27.00 |
| 28 | 30.65 | 28.85 | 26.00 | 22.00 | 24.00 | 29.00 |
| 30 | 32.65 | 30.85 | 28.00 | 24.00 | 26.00 | 31.00 |
| 32 | 34.65 | 32.85 | 30.00 | 26.00 | 28.00 | 33.00 |
| 34 | 36.65 | 34.85 | 32.00 | 28.00 | 30.00 | 35.00 |
| 36 | 38.65 | 36.85 | 34.00 | 30.00 | 32.00 | 37.00 |
| 38 | 40.65 | 38.85 | 36.00 | 32.00 | 34.00 | 39.00 |
| 40 | 42.65 | 40.85 | 38.00 | 34.00 | 36.00 | 41.00 |
| 42 | 44.65 | 42.85 | 40.00 | 36.00 | 38.00 | 43.00 |
| 44 | 46.65 | 44.85 | 42.00 | 38.00 | 40.00 | 45.00 |
| 46 | 48.65 | 46.85 | 44.00 | 40.00 | 42.00 | 47.00 |
| 48 | 50.65 | 48.85 | 46.00 | 42.00 | 44.00 | 49.00 |
| 50 | 52.65 | 50.85 | 48.00 | 44.00 | 46.00 | 51.00 |

- NOTES:
- FOR ILLUSTRATION PURPOSES, 20 CIRCUIT SIZE WAFER IS SHOWN.
 - MATERIAL :
HOUSING & CAP : 30% G.F., NYLON 46, UL94V-0, COLOR BLACK.
PIN : 0.50MM SQ.PHOSPHOR BRONZE.
 - PLATING : 0.38um/15uin GOLD IN CONTACT AREA AND 1.88um/75uin MIN.TIN IN SOLDER TAIL AREA OVER 1.27um/50uin MIN.NICKEL OVERALL.
 - PRODUCT SPECIFICATION PS-87831-027 APPLIES.
 - COPLANARITY IS TO BE MEASURED BY RESTING THE SOLDER TAIL ON A GAUGE SURFACE.
 - NO SIDE LOCKING SLOT FROM 4 TO 12 CKT SIZE.
 - CKT 4 & 6 HAS NO IDENTIFICATION TAG.
 - POSITION OF CAP TO BE LOCATED AT CENTER OF DIMENSION 'A' REGARDLESS OF CIRCUIT SIZE.
 - TOP SURFACE OF CAP TO BE FLAT FOR THE PURPOSE OF PICK-&-PLACE BY VACUUM SUCTION NOZZLE.
 - THIS HEADER MATES WITH MOLEX:
a) CRIMP RECEPTACLE HOUSING, 51110 SERIES WITH CRIMP TERMINAL, 50394 SERIES.
b) 2MM MILLIGRID DUAL ROW IDT, 87568 SERIES.
 - NO CENTRE POLARIZATION SLOT FOR CKT SIZE 4 AND 6.
 - PARTS SHALL BE PACKED IN MOISTURE BARRIER BAG.

25-05345

| | | | | | | | | | |
|--|-------------------------------|---|---------|-----------------------------------|--------------------|---|-------------------------------------|----------------------------|--|
| ADD ILLUSTRATION EC NO: S2009-0556 DRWN:SKANG CHKD:ATSEE APPR:MLONG | QUALITY SYMBOLS ▽=0 ◻=0 | GENERAL TOLERANCES (UNLESS SPECIFIED) | | DIMENSION STYLE MM ONLY | | SCALE NTS | DESIGN UNITS METRIC | THIRD ANGLE PROJECTION | |
| | | 4 PLACES ± --- ± --- 3 PLACES ± --- ± --- 2 PLACES ± 0.2 ± --- 1 PLACE ± --- ± --- | mm INCH | DRAWN BY ATSEE | DATE 2003/10/14 | TITLE MGRID, SHROUDED HEADER SMT, W/PEGS/CAP FOR PICK & PLACE IN TUBE AND T&R | | | |
| | | ANGULAR ± 3 ° | | CHECKED BY KCLING | DATE 2003/11/07 | MOLEX MOLEX INCORPORATED | | | |
| | | DRAFT WHERE APPLICABLE MUST REMAIN WITHIN DIMENSIONS | | APPROVED BY SKTOH | DATE 2003/11/07 | MATERIAL NO. SEE TABLE | DOCUMENT NO. SD-87832-006 | SHEET NO. 1 OF 4 | |

TUBE PACKAGING

WITH CAP IN TUBE

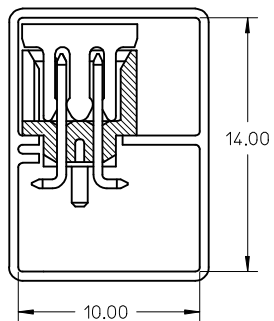

WITHOUT CAP IN TUBE

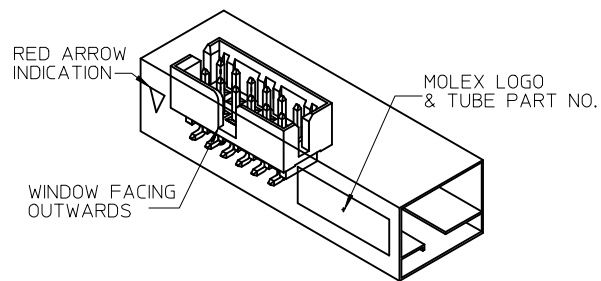
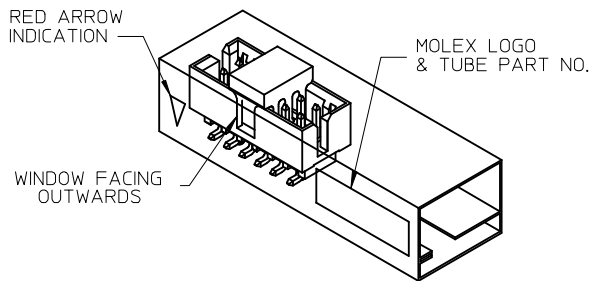
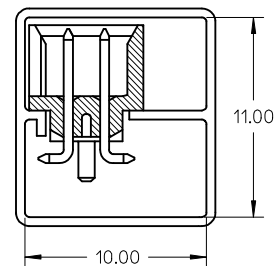

REF : ORIENTATION OF PART IN TUBE
(FOR THE REFERENCE OF PART/TUBE ASSEMBLY)

| | | | | | | | | | | |
|---|--|--------------------|---|--|--------------------------------------|--|---|--------------|------------------------|--|
| ADD ILLUSTRATION EC NO: S2009-0556 DRWN:SKANG CHKD:ATSEE APPR:MLONG | 2009/02/23 2009/02/23 2009/02/23 | DESCRIPTION REV | QUALITY SYMBOLS | GENERAL TOLERANCES (UNLESS SPECIFIED) | DIMENSION STYLE | | SCALE | DESIGN UNITS | THIRD ANGLE PROJECTION | |
| | | | $\nabla=0$ $\sphericalcap=0$ | | mm | INCH | NTS | METRIC | | |
| | | | 4 PLACES ± --- ± --- 3 PLACES ± --- ± --- 2 PLACES ± 0.2 ± --- 1 PLACE ± --- ± --- | | DRAWN BY DATE ATSEE 2003/10/14 | | TITLE | | | |
| | | | ANGULAR ± 3 ° | | CHECKED BY DATE KCLING 2003/11/07 | | MGRID, SHROUDED HEADER SMT, W/PEGS/CAP FOR PICK & PLACE IN TUBE AND T&R | | | |
| | | | | APPROVED BY DATE SKTOH 2003/11/07 | | MOLEX INCORPORATED | | | | |
| | | | | MATERIAL NO. | | DOCUMENT NO. | | | SHEET NO. | |
| | | | | DRAFT WHERE APPLICABLE MUST REMAIN WITHIN DIMENSIONS | | SEE TABLE | | | SD-87832-006 | |
| | | | | SIZE A3 | | THIS DRAWING CONTAINS INFORMATION THAT IS PROPRIETARY TO MOLEX INCORPORATED AND SHOULD NOT BE USED WITHOUT WRITTEN PERMISSION | | | | |

EMBOSSED CARRIER TAPE LAYOUT
24 CKT USE FOR ILLUSTRATION ONLY

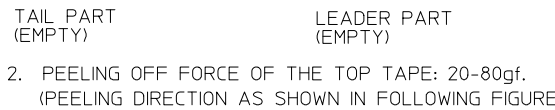
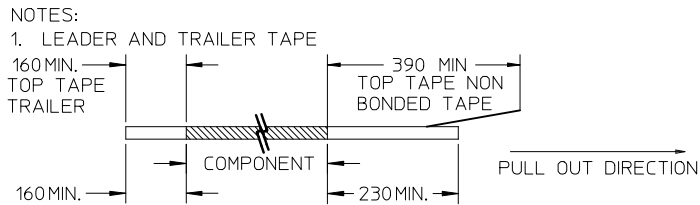
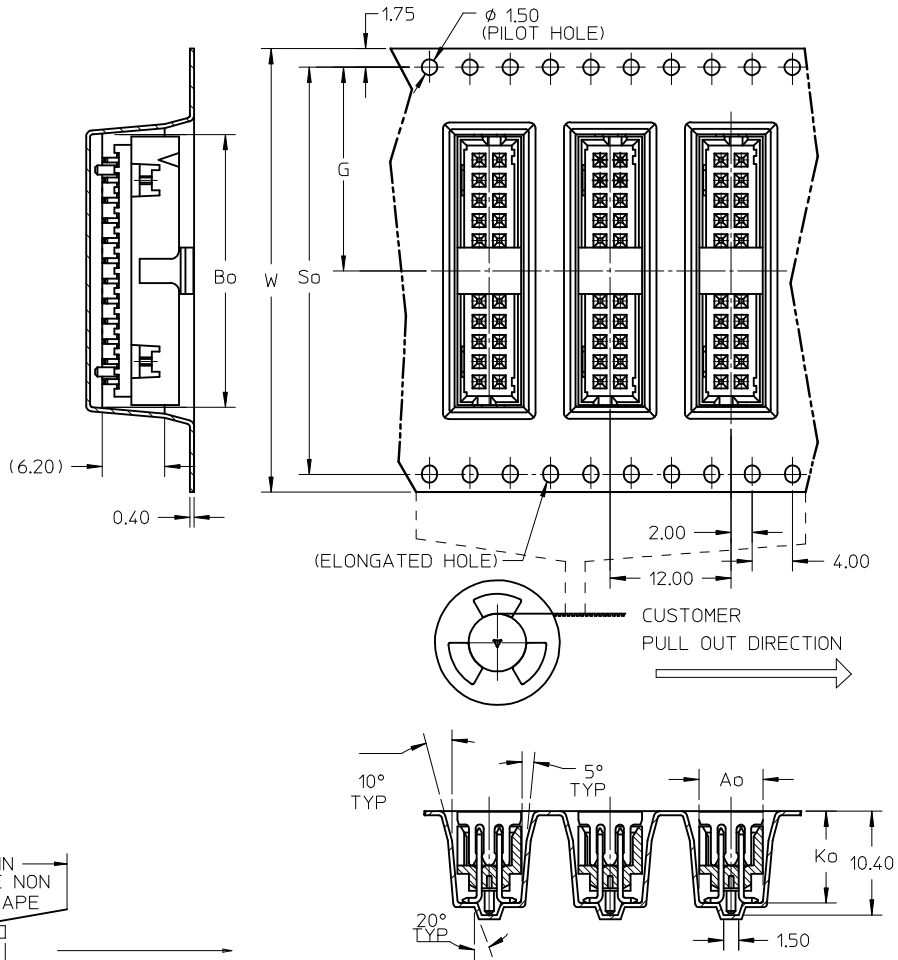

3. PACKAGING STANDARD IS AS PER EIA-481.

| | | | | | | | | | |
|---|-------------------------------|---|---------|----------------------------|--------------------|--|------------------------------|---------------------|--|
| ADD ILLUSTRATION EC NO: S2009-0556 DRWN:SKANG CHKD:ATSEE APPR:MLONG | QUALITY SYMBOLS ▽=0 ◻=0 | GENERAL TOLERANCES (UNLESS SPECIFIED) | | DIMENSION STYLE MM ONLY | SCALE NTS | DESIGN UNITS METRIC | THIRD ANGLE PROJECTION | | |
| | | 4 PLACES ± --- ± --- 3 PLACES ± --- ± --- 2 PLACES ± 0.2 ± --- 1 PLACE ± --- ± --- | mm INCH | DRAWN BY ATSEE | DATE 2003/10/14 | TITLE MGRID, SHROUDED HEADER SMT, W/PEGS/CAP FOR PICK & PLACE IN TUBE AND T&R | | | |
| | | ANGULAR ± 3 ° | | CHECKED BY KCLING | DATE 2003/11/07 | MOLEX INCORPORATED | | | |
| | | DRAFT WHERE APPLICABLE MUST REMAIN WITHIN DIMENSIONS | | APPROVED BY SKTOH | DATE 2003/11/07 | MATERIAL NO. SEE TABLE | DOCUMENT NO. SD-87832-006 | SHEET NO. 3 OF 4 | |

PLS REFER TO PART 87832-**08 FOR CENTER LOCKING SLOT OPTION.

| REG. OPTION | P/N W/O CAP IN TUBE | P/N W/CAP IN TUBE | P/N W/CAP IN TAPE & REEL | CKT SIZE | DIMENSION | | | | | |
|-------------|---------------------|-------------------|--------------------------|----------|-----------|-------|-------|-------|-------|-------|
| | | | | | W | G | Bo | So | Ao | Ko |
| NO | 87832-0420 | 87832-0422 | 87832-5122 | 4 | 16.00 | 7.50 | 7.15 | ----- | 6.40 | 9.30 |
| YES | 87832-0620 | 87832-0622 | 87832-5222 | 6 | 24.00 | 11.50 | 9.15 | ----- | 6.40 | 9.30 |
| YES | 87832-0820 | 87832-0822 | 87832-5322 | 8 | 24.00 | 11.50 | 11.05 | ----- | 6.40 | 9.30 |
| YES | 87832-1020 | 87832-1022 | 87832-5422 | 10 | 24.00 | 11.50 | 13.05 | ----- | 6.40 | 9.30 |
| YES | 87832-1220 | 87832-1222 | 87832-5522 | 12 | 32.00 | 14.20 | 15.15 | 28.40 | 6.85 | 9.30 |
| YES | 87832-1420 | 87832-1422 | 87832-5622 | 14 | 32.00 | 14.20 | 17.05 | 28.40 | 6.40 | 9.30 |
| YES | 87832-1620 | 87832-1622 | 87832-5722 | 16 | 32.00 | 14.20 | 19.05 | 28.40 | 6.40 | 9.30 |
| YES | 87832-1820 | 87832-1822 | 87832-5822 | 18 | 44.00 | 20.20 | 21.05 | 40.40 | 6.40 | 9.30 |
| YES | 87832-2020 | 87832-2022 | 87832-5922 | 20 | 44.00 | 20.20 | 23.05 | 40.40 | 6.40 | 9.30 |
| YES | 87832-2220 | 87832-2222 | 87832-6022 | 22 | 44.00 | 20.20 | 25.05 | 40.40 | 6.40 | 9.30 |
| YES | 87832-2420 | 87832-2422 | 87832-6122 | 24 | 44.00 | 20.20 | 27.05 | 40.40 | 6.40 | 9.30 |
| YES | 87832-2620 | 87832-2622 | 87832-6222 | 26 | 44.00 | 20.20 | 29.05 | 40.40 | 6.40 | 9.30 |
| YES | 87832-2820 | 87832-2822 | 87832-6322 | 28 | 56.00 | 26.20 | 31.05 | 52.40 | 6.40 | 9.30 |
| YES | 87832-3020 | 87832-3022 | 87832-6422 | 30 | 56.00 | 26.20 | 33.05 | 52.40 | 6.40 | 9.30 |
| YES | 87832-3220 | 87832-3222 | ----- | 32 | ----- | ----- | ----- | ----- | ----- | ----- |
| YES | 87832-3420 | 87832-3422 | 87832-6622 | 34 | 56.00 | 26.20 | 37.05 | 52.40 | 6.40 | 9.30 |
| YES | 87832-3620 | 87832-3622 | ----- | 36 | ----- | ----- | ----- | ----- | ----- | ----- |
| YES | 87832-3820 | 87832-3822 | ----- | 38 | ----- | ----- | ----- | ----- | ----- | ----- |
| YES | 87832-4020 | 87832-4022 | 87832-6922 | 40 | 56.00 | 26.20 | 43.05 | 52.40 | 6.40 | 9.30 |
| YES | 87832-4220 | 87832-4222 | ----- | 42 | ----- | ----- | ----- | ----- | ----- | ----- |
| YES | 87832-4420 | 87832-4422 | 87832-7122 | 44 | 56.00 | 26.20 | 46.80 | 52.40 | 6.40 | 9.30 |
| YES | 87832-4620 | 87832-4622 | 87832-7222 | 46 | 56.00 | 26.20 | 47.05 | 52.40 | 6.40 | 9.30 |
| YES | 87832-4820 | 87832-4822 | ----- | 48 | ----- | ----- | ----- | ----- | ----- | ----- |
| YES | 87832-5020 | 87832-5022 | 87832-7422 | 50 | 72.00 | 34.20 | 53.05 | 68.40 | 6.40 | 9.30 |

| | | | | | | | | |
|---|--|--------------------|--|--|--|---|------------------------------|------------------------|
| ADD ILLUSTRATION EC NO: S2009-0556 DRWN:SKANG CHKD:ATSEE APPR:MLONG | 2009/02/23 2009/02/23 2009/02/23 | DESCRIPTION REV | QUALITY SYMBOLS | GENERAL TOLERANCES (UNLESS SPECIFIED) | DIMENSION STYLE | SCALE | DESIGN UNITS | THIRD ANGLE PROJECTION |
| | | | ▽=0 □=0 | mm INCH 4 PLACES ± --- ± --- 3 PLACES ± --- ± --- 2 PLACES ± 0.2 ± --- 1 PLACE ± --- ± --- ANGULAR ± 3 ° | MM ONLY DRAWN BY DATE ATSEE 2003/10/14 CHECKED BY DATE KCLING 2003/11/07 APPROVED BY DATE SKTOH 2003/11/07 | NTS TITLE MGRID, SHROUDED HEADER SMT, W/PEGS/CAP FOR PICK & PLACE IN TUBE AND T&R | METRIC MOLEX INCORPORATED | SHEET NO. 4 OF 4 |
| | | | DRAFT WHERE APPLICABLE MUST REMAIN WITHIN DIMENSIONS | SEE TABLE | MATERIAL NO. SD-87832-006 | DOCUMENT NO. | | |
| | | | SIZE A3 | THIS DRAWING CONTAINS INFORMATION THAT IS PROPRIETARY TO MOLEX INCORPORATED AND SHOULD NOT BE USED WITHOUT WRITTEN PERMISSION | | | | |